



# SD54 SMD Power Inductor



## Features:

- Low Profile 4.8 mm Max. height.
- Inductance range 0.6  $\mu\text{H}$  ~ 220  $\mu\text{H}$ .
- 1500 pcs per reel.
- Custom values are welcomed.

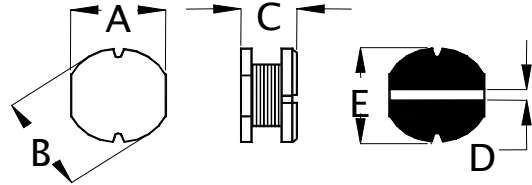

Mechanical Dimmensions (Unit: mm)					
Part Number	A	B	C	D	E
SD54	$\pm 0.3$	$\pm 0.3$	$\pm 0.3$	Ref.	$\pm 0.5$
SD54	5.2	5.8	4.5	2.0	5.8

Electrical Specifications				
Part Number	L@ 100kHz ( $\mu\text{H}$ )	DCR Max. ( $\Omega$ )	$I_{\text{sat}}$ (Amp)	$I_{\text{rms}}$ (Amp)
SD54-R60U	0.6+40% -20%	0.0182	11.00	8.88
SD54-1R0MU	1.0 $\pm$ 20%	0.0198	9.46	7.65
SD54-1R5MU	1.5 $\pm$ 20%	0.0257	8.28	6.68
SD54-1R8MU	1.8 $\pm$ 20%	0.0327	7.28	5.87
SD54-2R2MU	2.2 $\pm$ 20%	0.0410	7.01	5.66
SD54-2R7MU	2.7 $\pm$ 20%	0.0455	6.41	5.17
SD54-3R3MU	3.3 $\pm$ 20%	0.0555	5.53	4.46
SD54-6R8MU	6.8 $\pm$ 20%	0.082	3.82	3.08
SD54-100MU	10.0 $\pm$ 20%	0.10	1.98	2.08
SD54-120MU	12.0 $\pm$ 20%	0.12	1.80	1.89
SD54-150LU	15.0 $\pm$ 15%	0.14	1.62	1.70
SD54-180LU	18.0 $\pm$ 15%	0.15	1.53	1.61
SD54-220LU	22.0 $\pm$ 15%	0.18	1.35	1.42
SD54-270LU	27.0 $\pm$ 15%	0.20	1.26	1.32
SD54-330KU	33.0 $\pm$ 10%	0.23	1.15	1.21
SD54-390KU	39.0 $\pm$ 10%	0.32	0.99	1.04
SD54-470KU	47.0 $\pm$ 10%	0.37	0.90	0.95
SD54-560KU	56.0 $\pm$ 10%	0.42	0.81	0.86
SD54-680KU	68.0 $\pm$ 10%	0.46	0.68	0.71
SD54-820KU	82.0 $\pm$ 10%	0.60	0.64	0.67
SD54-101KU	100.0 $\pm$ 10%	0.70	0.60	0.63
SD54-121KU	120.0 $\pm$ 10%	0.93	0.51	0.54
SD54-151KU	150.0 $\pm$ 10%	1.10	0.48	0.51
SD54-181KU	180.0 $\pm$ 10%	1.38	0.44	0.47
SD54-221KU	220.0 $\pm$ 10%	1.57	0.43	0.45

## Notes:

1.  $I_{\text{sat}}$ : 10% inductance roll off.
2.  $I_{\text{rms}}$ : 40 °C temperature rise.
3. Operating temperature: -40 ~130 °C.