



SD73H SMD Power Inductor



Features:

- Low Profile 3.8 mm Max. height.
- Inductances range 0.3 μ H ~ 470 μ H.
- 1000 pcs per reel.
- H class wire is used to ensure solderability.
- Coplanarity = 0.10mm.

Mechanical Dimmensions (Unit: mm)					
Part Number	A	B	C	D	E
SD73H	± 0.3	± 0.3	± 0.3	Ref.	± 0.5
SD73H	7.0	7.8	3.5	3.0	8.0

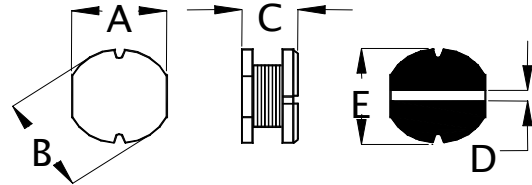

Electrical Specifications				
Part Number	L @ 100 kHz (μ H)	DCR Max. (Ω)	I _{sat} (Amp)	I _{rms} (Amp)
SD73H-R30U	0.3+40% -20%	0.0045	13.50	8.00
SD73H-R60MU	0.6 \pm 20%	0.006	8.40	8.60
SD73H-R80MU	0.8 \pm 20%	0.015	10.62	6.66
SD73H-1R0U	1.0 +40% -20%	0.010	8.10	6.72
SD73H-1R5MU	1.5 \pm 20%	0.015	6.12	5.08
SD73H-2R2MU	2.2 \pm 20%	0.020	5.22	4.33
SD73H-2R7MU	2.7 \pm 20%	0.022	4.32	3.58
SD73H-3R3MU	3.3 \pm 20%	0.025	4.10	3.40
SD73H-4R7MU	4.7 \pm 20%	0.030	3.20	2.66
SD73H-6R8MU	6.8 \pm 20%	0.050	2.75	2.28
SD73H-8R2MU	8.2 \pm 20%	0.070	2.34	2.16
SD73H-100MU	10.0 \pm 20%	0.0803	1.89	1.99
SD73H-120MU	12.0 \pm 20%	0.0897	1.71	1.80
SD73H-150LU	15.0 \pm 15%	0.104	1.53	1.61
SD73H-180LU	18.0 \pm 15%	0.111	1.49	1.56
SD73H-220LU	22.0 \pm 15%	0.129	1.26	1.32
SD73H-270LU	27.0 \pm 15%	0.153	1.17	1.23
SD73H-330KU	33.0 \pm 10%	0.170	1.04	1.09
SD73H-390KU	39.0 \pm 10%	0.217	0.95	0.99
SD73H-470KU	47.0 \pm 10%	0.252	0.90	0.95
SD73H-560KU	56.0 \pm 10%	0.282	0.86	0.90
SD73H-680KU	68.0 \pm 10%	0.332	0.68	0.71
SD73H-820KU	82.0 \pm 10%	0.406	0.64	0.67
SD73H-101KU	100.0 \pm 10%	0.481	0.60	0.63
SD73H-121KU	120.0 \pm 10%	0.536	0.49	0.52
SD73H-151KU	150.0 \pm 10%	0.755	0.47	0.49
SD73H-181KU	180.0 \pm 10%	1.022	0.43	0.45
SD73H-221KU	220.0 \pm 10%	1.200	0.38	0.40
SD73H-271KU	270.0 \pm 10%	1.306	0.34	0.36
SD73H-331KU	330.0 \pm 10%	1.495	0.30	0.31
SD73H-471KU	470.0 \pm 10%	2.500	0.26	0.27

Notes:

1. I_{sat}: 10% inductance roll off.
2. I_{rms}: 40 °C temperature rise.
3. Operating temperature: -25 ~130 °C.