



SD75 SMD Power Inductor



Features:

- Low Profile 5.3 mm height.
- Inductance range 1 μ H ~ 470 μ H.
- 500 pcs per reel.

Mechanical Dimmensions (Unit: mm)					
Part Number	A	B	C	D	E
SD75	± 0.3	± 0.3	± 0.3	Ref.	± 0.5
SD75	7.0	7.8	5.0	3.0	8.0

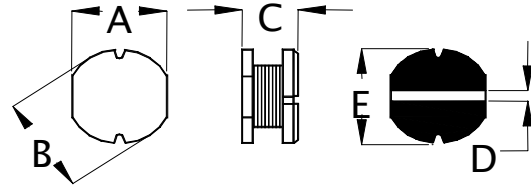

Electrical Specifications				
Part Number	L @ 100 kHz (μ H)	DCR Max. (Ω)	I _{sat} (Amp)	I _{rms} (Amp)
SD75-1R0U	1.0 +40% -20%	0.0088	7.56	6.27
SD75-1R5MU	1.5 \pm 20%	0.015	6.57	5.45
SD75-2R2MU	2.2 \pm 20%	0.018	5.76	4.78
SD75-2R7MU	2.7 \pm 20%	0.020	4.86	4.03
SD75-3R3MU	3.3 \pm 20%	0.022	4.50	3.74
SD75-3R9MU	3.9 \pm 20%	0.025	4.14	3.44
SD75-4R7MU	4.7 \pm 20%	0.031	3.87	3.21
SD75-5R6MU	5.6 \pm 20%	0.035	3.51	2.91
SD75-6R8MU	6.8 \pm 20%	0.046	3.06	2.54
SD75-8R2MU	8.2 \pm 20%	0.055	2.97	2.43
SD75-100KU	10.0 \pm 10%	0.070	2.34	2.25
SD75-120KU	12.0 \pm 10%	0.080	2.07	2.18
SD75-150KU	15.0 \pm 10%	0.090	1.94	2.03
SD75-180KU	18.0 \pm 10%	0.100	1.89	1.99
SD75-220KU	22.0 \pm 10%	0.110	1.76	1.85
SD75-270KU	27.0 \pm 10%	0.120	1.49	1.56
SD75-330KU	33.0 \pm 10%	0.130	1.35	1.42
SD75-390KU	39.0 \pm 10%	0.160	1.26	1.32
SD75-470KU	47.0 \pm 10%	0.180	1.17	1.23
SD75-560KU	56.0 \pm 10%	0.240	1.04	1.09
SD75-680KU	68.0 \pm 10%	0.280	0.99	1.04
SD75-820KU	82.0 \pm 10%	0.370	0.90	0.95
SD75-101KU	100.0 \pm 10%	0.430	0.77	0.81
SD75-121KU	120.0 \pm 10%	0.470	0.68	0.71
SD75-151KU	150.0 \pm 10%	0.640	0.60	0.63
SD75-181KU	180.0 \pm 10%	0.710	0.55	0.58
SD75-221KU	220.0 \pm 10%	0.960	0.51	0.54
SD75-271KU	270.0 \pm 10%	1.110	0.47	0.49
SD75-331KU	330.0 \pm 10%	1.260	0.43	0.45
SD75-391KU	390.0 \pm 10%	1.770	0.38	0.40
SD75-471KU	470.0 \pm 10%	1.960	0.34	0.36

Notes:

1. I_{sat}: 10% inductance roll off.
2. I_{rms}: 40 °C temperature rise.
3. Operating temperature: -25 ~130 °C.