



Power Puck Inductor PP4825 Series



1. Features:

- Excellent DC Bias performance.
- Inductance range: 200uH to 500uH.
- Hi-Pot, 2500 Vrms Coil Vs. Core.
- 25.0mmx48.0x50.0mm (LxODxH) Max. Custom value are welcomed.
- Operating Temperature Range -55°C to + 130°C; RoHS compliance.

2. Mechanical Dimension(Unit:mm):

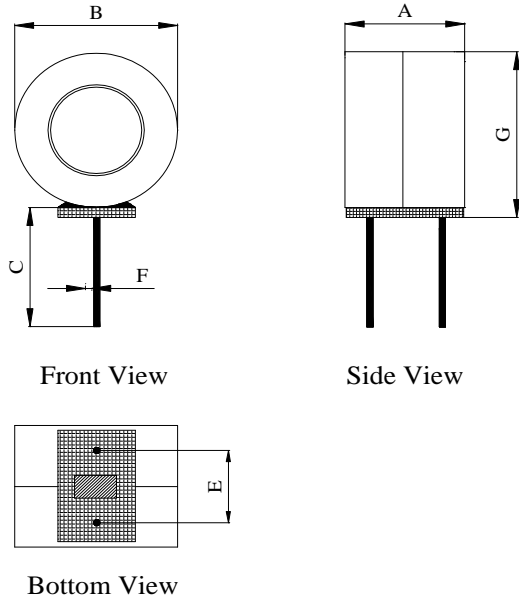

| Type | PP4825 |
|------|-----------------|
| A | 25.0 (Max.) |
| B | 48.0 (Max.) |
| C | 10.0 ± 1.0 |
| E | 12.0 ± 1.0 |
| F | See below table |
| G | 50.0 (Max.) |

3. Electrical Characteristic of PP4825 Series:

| Part Number | OCL (uH) ±20% | DCR (mΩ) Typ. | DCR (mΩ) Max. | Isat ¹ (A) @25°C | L@Isat ¹ (uH) Typ. | Isat ² (A) @25°C | L@Isat ² (uH) Typ. | Irms (A) @25°C | L@Irms (uH) Typ. | Dimension F (mm) |
|---------------|---------------|---------------|---------------|-----------------------------|-------------------------------|-----------------------------|-------------------------------|----------------|------------------|------------------|
| PP4825-201MHF | 200.0 | 26.0 | 35.0 | 8.0 | 183.8 | 18.0 | 143.2 | 18.0 | 143.2 | 1.5 |
| PP4825-301MHF | 300.0 | 40.0 | 52.0 | 7.0 | 277.9 | 16.0 | 214.0 | 15.0 | 222.4 | 1.3 |
| PP4825-501MHF | 500.0 | 88.0 | 115.0 | 5.0 | 461.2 | 11.0 | 362.9 | 11.0 | 362.9 | 1.0 |

Note:

- 1.OCL (Open Circuit Inductance) and L@Irms and L@Isat and DCR are measured at: 100KHz, 0.25V @25°C.
- 2.Isat¹: DC current that causes inductance to drop by approximately 10% from OCL.
- 3.Isat²: DC current that causes inductance to drop by approximately 30% from OCL.
- 3.Irms: DC current that causes an approximate temperature rise (ΔT) of 40°C.
- 4.Inductance Vs. DC bias curve, please see the next page to get more detail information.



Power Puck Inductor PP4825 Series

