



L5100 Series



1. Features:

- Power Line Chokes offer cost effective solution with wide inductance value from 47uH to 4700uH, custom values are welcomed ;
- High current output chokes, up to 25 Amp for 47uH ;
- Ideal for Switching Regulators, Power Amplifiers, RFI Suppression, Filters, Power Supplies, Speaker Crossover Networks, SCR and Triac Controls ;
- Operating Temperature Range -55°C to + 130°C; RoHs compliance ;



2. Mechanical Dimension(Unit:mm):

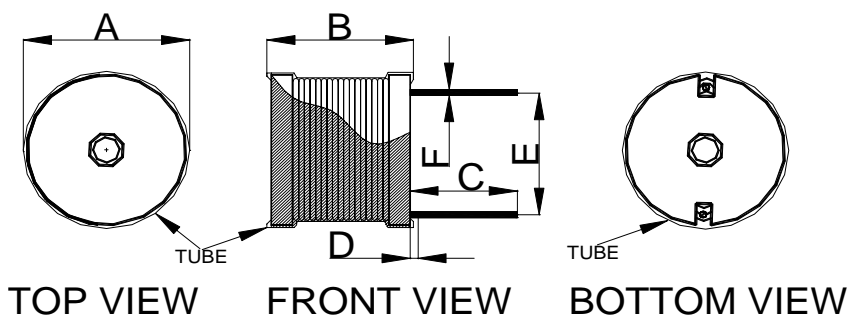

Type	L5100
A	26.0 (Max.)
B	27.0 (Max.)
C	5.0 ± 1.0
D	0.5 (Max.)
E	see below table
F	see below table

3. Electrical Characteristic of L5100 Series:

Part Number	OCL (uH) ±10%	DCR (mΩ) (Typ.)	DCR (mΩ) (Max.)	Isat (A) @25°C	L@Isat (uH) Typ.	Irms (A) @25°C	L@Irms (uH) Typ.	E (mm) (REF)	F (mm) ± 0.1
L5100-470KU	47	15.20	18	25.0	45.4	9.0	46.95	19.0	1.4
L5100-680KU	68	22.08	26	21.0	64.2	9.0	67.9	19.0	1.3
L5100-101KU	100	28.38	33	17.0	96.6	9.0	99.6	19.8	1.3
L5100-151KU	150	45.16	52	13.5	143.9	5.5	149.5	19.8	1.1
L5100-221KU	220	66.85	77	12.0	212.3	5.5	219.4	19.8	1.0
L5100-331KU	330	95.80	110.5	9.5	316.9	4.5	329.4	20.6	0.9
L5100-471KU	470	134.50	155	8.0	452.9	4.0	468.7	19.0	0.85
L5100-681KU	680	182.80	210.5	6.5	653.5	2.8	678.5	18.2	0.8
L5100-102KU	1000	295.50	340	5.6	963.2	2.0	1015.1	19.0	0.7
L5100-152KU	1500	402.60	463	4.5	1448.8	2.0	1497.0	19.0	0.65
L5100-222KU	2200	658.30	757	3.6	2106.9	1.3	2193.8	19.5	0.55
L5100-332KU	3300	853.78	982	3.1	3174.0	1.3	3289.0	19.0	0.55
L5100-472KU	4700	1242.50	1429	2.5	4523.8	1.0	4686.0	19.0	0.5

Note:

1>. Open Circuit Inductance(OCL) and L@ I rms and L @Isat are measured at: 10KHz, 1.0V ;(Ta=25°C).

2>. Isat: DC current that causes inductance to drop approximately by 5% from OCL ;(Ta=25°C).

3>. I rms: DC current for an approximate temperature rise of 20°C without core loss ;

US 1 914 347 2474 ● Taiwan 886 972 022 388 ● Shenzhen 86 755 8418 6263 ● Shanghai 86 21 5424 5141 ● HK 852 9688 9767

Sales@inter-technical.com www.inter-technical.com , Rev.A , May 07, 2010



L5100 Series

Inductance vs. Current

