



L5101 Series



1. Features:

- Power Line Chokes offer cost effective solution with wide inductance value from 10uH to 560uH, custom values are welcomed ;
- High current output chokes, up to 27 Amp for 10uH ;
- Ideal for Switching Regulators, Power Amplifiers, RFI Suppression, Filters, Power Supplies, Speaker Crossover Networks, SCR and Triac Controls ;
- Operating Temperature Range -55°C to + 130°C; RoHs compliance ;



2. Mechanical Dimension(Unit:mm):

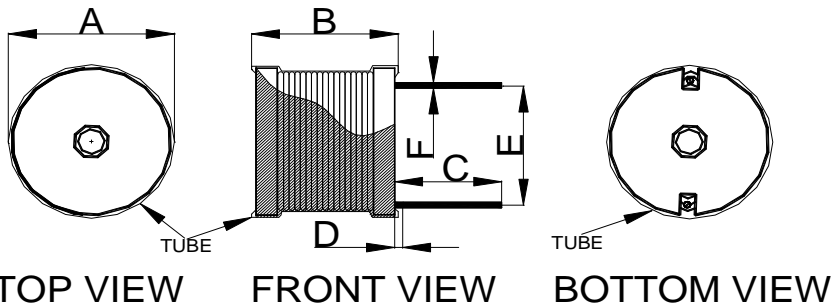

Type	L5101
A	16.0 (Max.)
B	22.0 (Max.)
C	5.0 ± 1.0
D	0.5 (Max.)
E	See below table
F	See below table

3. Electrical Characteristic of L5101 Series:

Part Number	OCL	DCR	DCR	Isat	L@Isat	Irms	L@Irms	E	F
	(uH)	(mΩ)	(mΩ)	(A)	(uH)	(A)	(uH)	(mm)	(mm)
	±10%	(Typ.)	(Max.)	@25°C	Typ.	@25°C	Typ.	(REF)	± 0.1
L5101-100KU	10	6.8	8.5	27.0	9.6	9.0	9.9	14.0	1.40
L5101-150KU	15	10.2	12.5	24.5	14.5	7.2	14.9	12.7	1.20
L5101-220KU	22	17.42	21.0	20.0	21.0	5.5	21.9	12.7	1.00
L5101-330KU	33	26.07	31.5	16.0	31.9	4.0	32.9	10.4	0.85
L5101-470KU	47	45.75	55.0	13.4	45.0	2.8	46.8	11.9	0.70
L5101-680KU	68	62.99	75.6	11.2	66.0	2.8	67.9	12.70	0.65
L5101-101KU	100	77.43	93.0	9.2	96.9	2.8	99.9	12.70	0.65
L5101-151KU	150	112.39	135.0	7.9	145.2	1.6	149.9	12.20	0.60
L5101-221KU	220	151.70	182.0	4.8	212.0	1.6	219.9	12.20	0.60
L5101-331KU	330	246.20	296.0	5.0	315.5	1.3	329.9	12.20	0.50
L5101-471KU	470	361.90	435.0	4.1	450.0	0.8	469.9	11.40	0.45
L5101-561KU	560	392.10	471.0	3.7	535.6	0.8	559.9	11.40	0.45

- Note:**
- 1>.Open Circuit Inductance(OCL) and L@ Irms and L @Isat are measured at: 10KHz, 1.0V ;(Ta=25°C).
 - 2>.Isat: DC current that causes inductance to drop approximately by 5% from OCL ;(Ta=25°C).
 - 3>. Irms: DC current for an approximate temperature rise of 20°C without core loss ;



L5101 Series

Inductance vs. Current

